

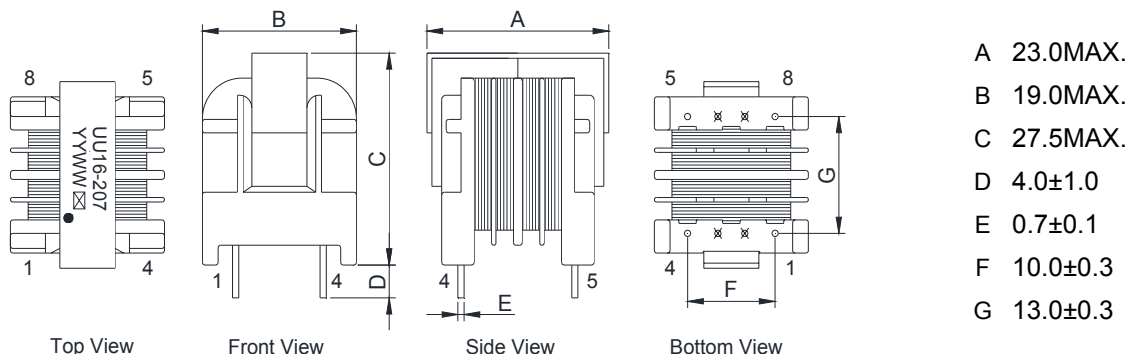

UU TYPE COMMON MODE CHOKE

Product Specification

1. Physical Dimensions (Unit:mm)



Notes:

- (1). Marking type is laser printing
- (2). YY: Year Code; WW: Week Code
- (3).  : When making samples, S is used to represent the product is a sample.
- (4).  : Use different letters or numbers to represent the products are produced from different production lines.
- (5). Size D not including soldering tags
- (6). PIN 2,3,6,7 cut off

2. Connection

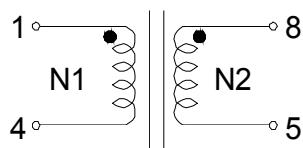

"●" Start of winding

3. Recommended Pad Layout (Unit:mm)

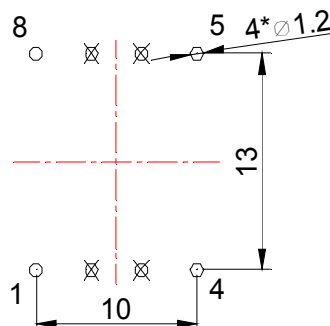

Items	Winding	Specifications	Test Conditions
Inductance	L(1-4)	7.5mH Min	at 1kHz, 0.25V
	L(8-5)	7.5mH Min	
DCR	R(1-4)	0.55Ω MAX.	at 25℃
	R(8-5)	0.55Ω MAX.	
Hi-Pot	Win. To Core	500VAC	5mA.3Sec.